

3/16" SCALE
50' OUTSIDE BRACED BOXCAR

INSTRUCTION BOOKLET



!#@*?! TRAIN STUFF

175 MONMOUTH BLVD.
OCEANPORT, N.J.
07767

INTRODUCTION

#24903 S00 Line

This kit was designed from the S00 Line 50' outside braced, plug door box car. Several variations of the S00 style box cars can be made from this kit. Two examples are shown on the front and back covers. Some of their cars have a white door, or are missing the "Colormark" working and have a red strip along the bottom of the car.

Cover

This car was on a siding along the Raritan River Railroad freight shed in South Amboy, New Jersey.

#24903 S00 Line

50' Outside braced box car kit

Unpack and inspect kit against the parts list. If anything is missing or damaged, contact us now for replacement. Read the instructions thoroughly and familiarize yourself with the parts and sequence of assembly. For a smooth metal-like finish, use at least two coats of sander sealer on the roof and stripwoods. Sand with 00 steel wool, or fine sandpaper after each coat.

Roof Detail

Using the 1/32"x 1/32" (blue) stripwood, cut and cement two pieces to form the overhang² for the ends of the roof. Measure and cut 14 roof braces³ from the 1/16" tee section (refer to picture on center page). Cement braces on one side of roof, wait 'til dry then score the center of brace with a blade. Glue, bend and hold with paper clips. Ends of roof braces can be trimmed and rounded at this time. Cement the Murphy style diagonal roof sections⁴ in place. You can use center photo for reference. The roof can be painted now.

Side Detail

Clean steel sides⁵ with vinegar to

remove the protective film layer covering it. This will allow the paint to adhere to the metal. Use the $3/32$ " x $3/64$ " (purple) for top brace.⁶ Cut the 32 outside braces⁷ using the $5/64$ " x $1/32$ " (green), referring to center page photo. Glue in place. The door⁸ fits between the two center braces^A made from the $1/32$ " x $3/32$ " (brown) stripwood, and butts on the top brace.⁶ Using the $1/32$ " x $1/32$ " (blue) strip, measure and cut the top door guide,^C cement this in place. Construct the lower door guide⁸ using the $3/64$ " x $1/32$ " (red) wood. Door rods⁹ made from the 1 $5/8$ " piping fit into the grooves on the door and are bent to fit into the door wheels.¹⁰ Door levers¹¹ to be made from the same wire can be added when the rods are in place. Using the thin wire, cut rungs¹² for side ladders.

The side braces can be scored with a triangular file for ease in placement. Cement these rungs in place. Door stops¹³ are made with the $1/32$ " x $5/32$ " (green) scraps. Paint the sides now.

Underframe Detail

Scale trucks-

Place the bolster¹⁴ with coupler pockets extending by $3/32$ ". Measure, cut,

and cement the grooved center sill¹⁵ in place. Pre-drilling the center sill holes for the brake piping system before cementing is a good idea. Use the 5/32" x 3/32" (yellow) strip to make the large braces¹⁶ and install. Use 1/16" x 3/32" (orange) to make the 12 small braces¹⁷ and install. Cement the brake cylinder¹⁸, reservoir¹⁹ and triple valve²⁰ and levers with appropriate piping. The thick wire is for the main brake line²⁷ and the thin for the others. This can be painted now.

American Flyer trucks-

Use washers provided for bolster²² and trim away excess centersill that interferes with movement. Use wood screws to mount trucks. Add as much brake detail as desired.

Cement the roof to the endblocks, keeping the the undercut of the roof flush with the outside of the endblocks. Cement the floor to the endblocks also keeping it flush with all edges.

End Detail

Cement the low brake platform²³ and destination boards²⁴ to the cast ends²⁵ (see end detail drawing). Cement the brake

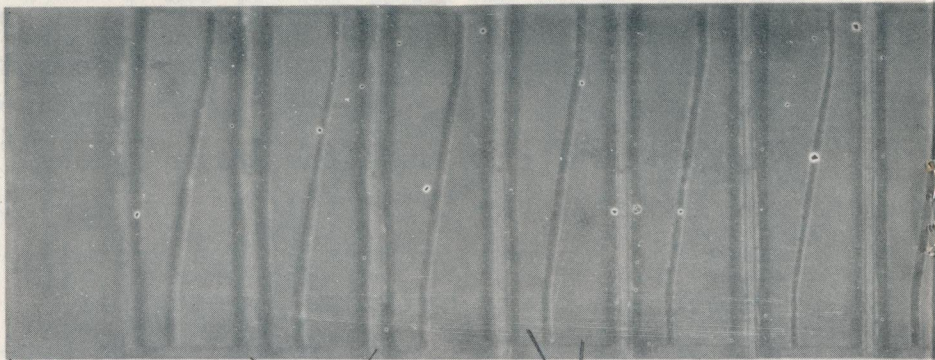

2

3

6

4

A

8

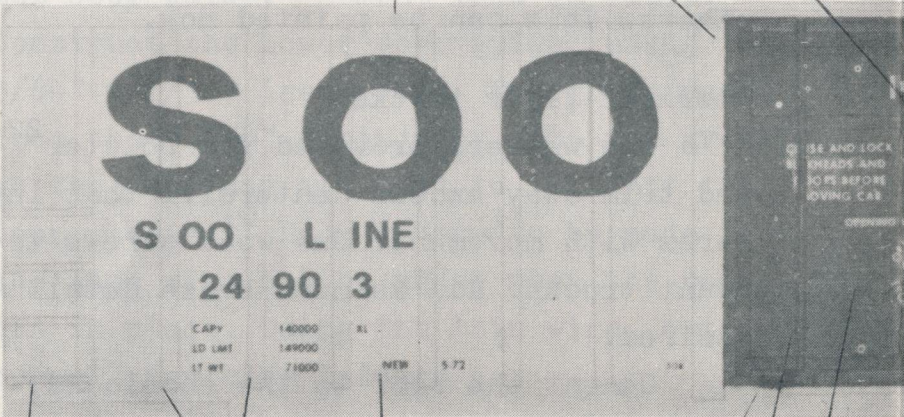

S O O

S O O L I N E

24 90 3

COPY	140000	SL	
SD LMT	149000		
LT #1	71000	NEW	5.72

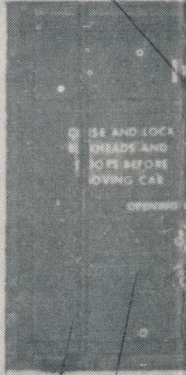

USE AND LOCK
HEADS AND
SCREWS BEFORE
MOVING CAB

12

14

7

8

27

15

10

11

9

18

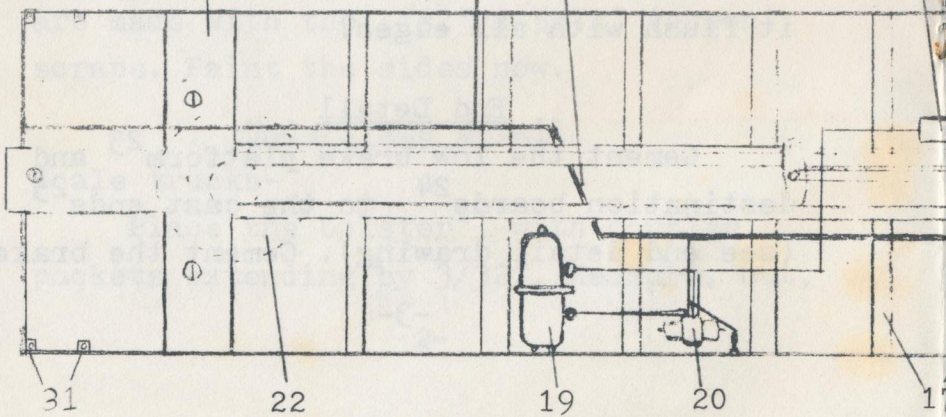

31

22

19

20

17

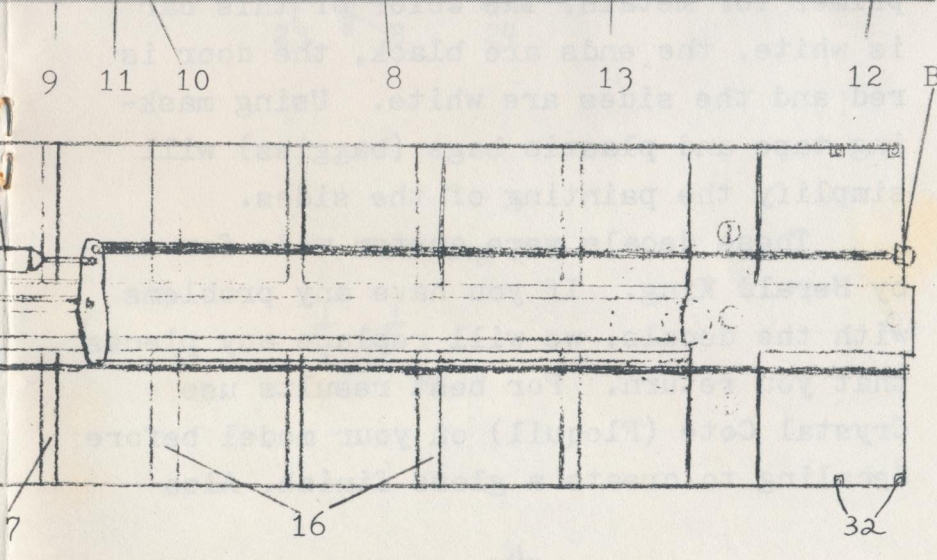
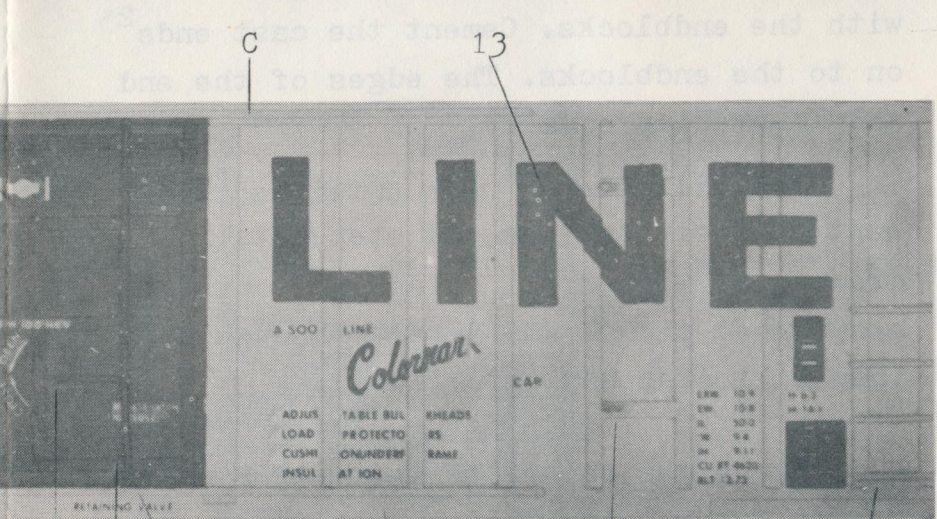
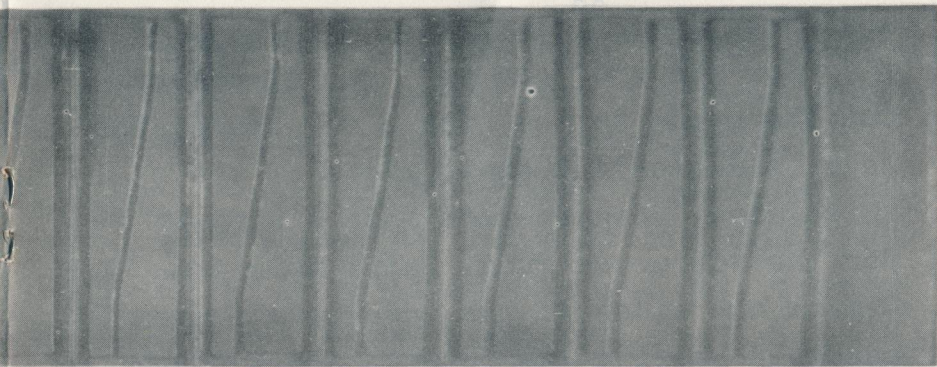

housing,²⁶ brake wheel²⁷, brake pulley^B, and wheel lever²⁸ in place.

Now the end ladders²⁹ can be placed. Cut the studs on the back of the ladder for level placement. A small piece of the thick wire³⁰ can be made into a support for the top cross rung. Paint this now. Cement the sides to the underbody frame assembly keeping the outside edges flush with the endblocks. Cement the cast ends²⁵ on to the endblocks. The edges of the end should overlap equally.

End sill steps³¹ are untwisted and bent to position (see end step detail drawing A). Pre-drill holes in floor for escutcheon pins³² and insert through hole into sill step and into floor.

Painting

The sides can be primed with a white primer for metals. The color of this car is white, the ends are black, the door is red and the sides are white. Using masking tape and plastic bags (baggies) will simplify the painting of the sides.

These decals were custom made for us by Herald King. If you have any problems with the decals, we will replace any pieces that you return. For best results use Crystal Cote (Floquil) on your model before decaling to create a gloss finish. Also

add a drop of detergent to your decal water.
The finished model can be sprayed with a
dull coat to hide the decal film.

For cementing wood to wood use white
glue (Elmer's). For wood to metal or
metal to metal you can use Duco cement,
contact cement, or epoxy.

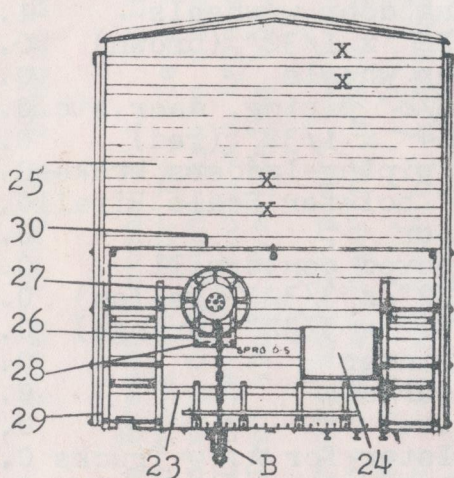

S00 LINE
24903

1w wrot stl whls
SPRG -

Drawing A



Parts list

#24903 S00 Line Outside Braced Boxcar

Qty.	Part #	No.	Description	Price
1	PA40T002		Modern style roof	\$0.75
2	PA40N001	2-C	1/32" x 1/32" (blue)	0.12
3	PA40N129	3	1/16" Tee strips	0.13
4	PA40S201	31	End sill steps	0.55
26	PA40D004	4	Murphy diagonal braces	0.75
2	PA40T016	5	Sides (BF & F)	1.00
8	PA40T011	32	Escutcheon pins	0.10
2	PA40N012	6	3/32" x 3/64" (purple)	0.12
7	PA40N007	7	5/64" x 1/32" (green)	0.30
7	PA40T018		Plug door w/wheels	1.00
1	PA40N008	A	3/32" x 1/32" (brown)	0.10
4	PA40T021	10	Door wheels	0.10
1	PA40T012	9	1 5/8" piping, door, etc.	0.10
1	PA40N002	8	3/64" x 1/32" (red)	0.06
2	PA40T009	12	1" piping-ladders brakes	0.10
2	PA40A062	14	5 1/2" bolster Scale Hirail	0.75
1	PA40T006		Floor	0.40
1	PA40N370	15	Grooved centersill	0.25
1	PA40N041	16	5/32" x 3/32" (yellow)	0.12
1	PA40N013	17	1/16" x 3/32" (orange)	0.06
1	PA40L018	18	Cylinder	0.15
1	PA40L019	19	Reservoir	0.12
1	PA40L020	20	Valve	0.08
2	PA40T014	22	Bolster for A.F. Trucks	0.10
4	PA40T012		Bolster screws	0.10
2	PA40T0119		End blocks	0.25
2	PA40T020	25	Youngstown cast end	0.50
2	PA40L207	23	Brake platform	0.25
2	PA40T005	24	Destination board	0.10
1	PA40L116	26	Ajax brake housing	0.09
1	PA40L115	28	Brake wheel w/levers	0.15
1	PA40L021	B	Brake pulley	0.05
4	PA40t015	29	End Ladders	0.65
2	PA40V005		S-scale converted kadees	1.10
2	PA40A252		Roller bearings w/scale	2.95
2	PA40A253		" " w/hirail	2.95
2	PA12A051		A.F.Knuckle coupler trk.	3.00
2	PA40D002		ACI Labels	0.10
1	PA40H003		S00 LINE Decals	1.55
1	M24903		Instruction Booklet	1.00

Part orders over \$10.00 are postpaid, Orders under that remit 10%

Other S-Guage Products

RAILBOX a 50' Outside Braced Boxcar Kit, This kit comes complete with basswood roof and strips, steel sides, brass stampings, cast modern doors and brake detail, Photoengravings, decals, ACI labels. Options as type of trucks are also available. Just about everything but the glue and paint.

#24901-0	Kit less trucks and coupler	\$9.95ppd
#24901-2	Kit with Ace roller bearing scale trucks & kadees converted to S.....	13.95
#24901-3	Kit with Ace roller bearing highrail & kadees.....	13.95
#24901-4	Kit with A.F. knuckle coupler trucks.....	13.95

#23901 Industrial Garbage Can Kit, This kit contains enough material to make five 3' 4" x 2' 7" (S-Scale) industrial Garbage cans. Has highly detailed injection molded can and galvanized steel lids.\$1.95ppd

