

PS 3000 COVERED HOPPER

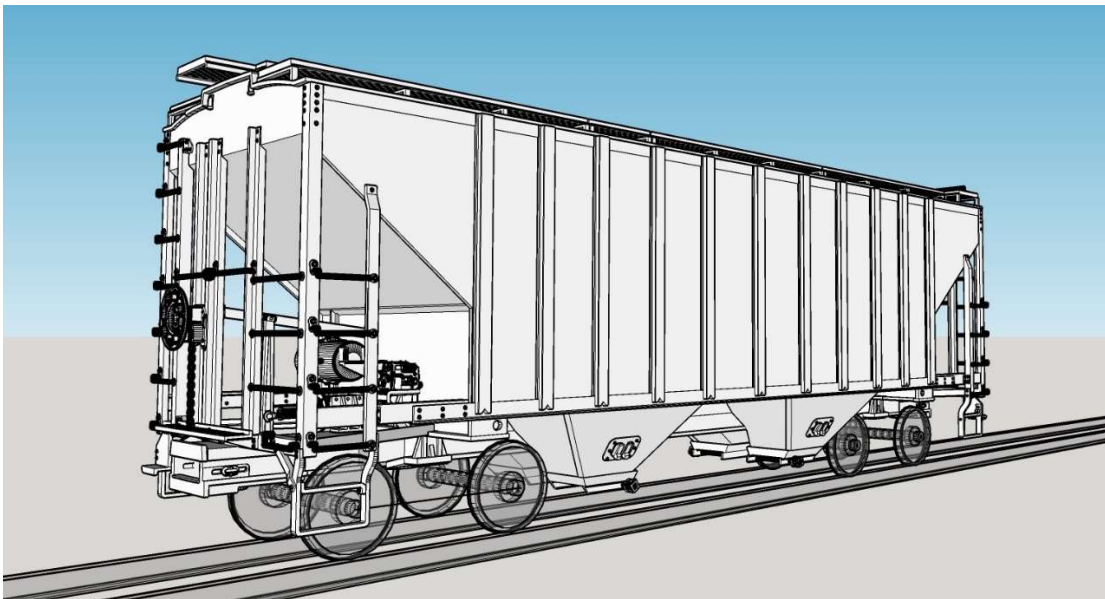

1. Wash all the parts in cool or cold soapy water. Test fit parts.

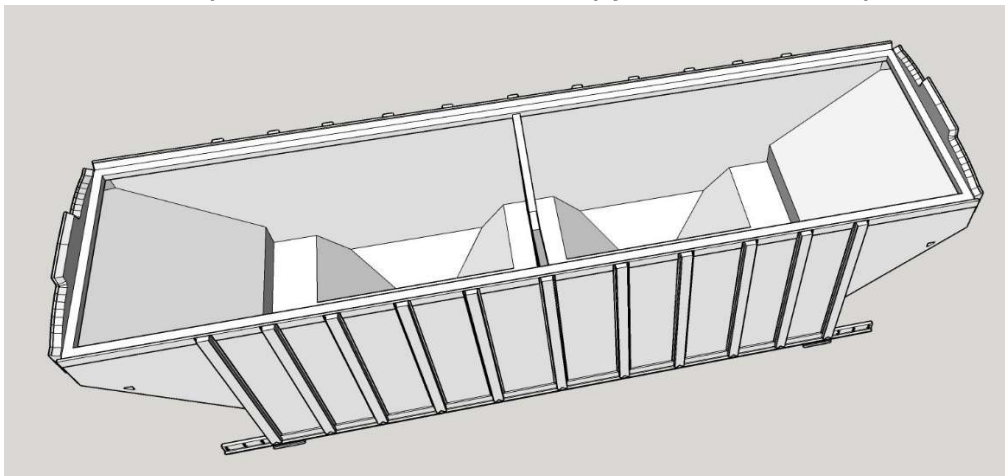

2. Install the triple valve and reservoir tank

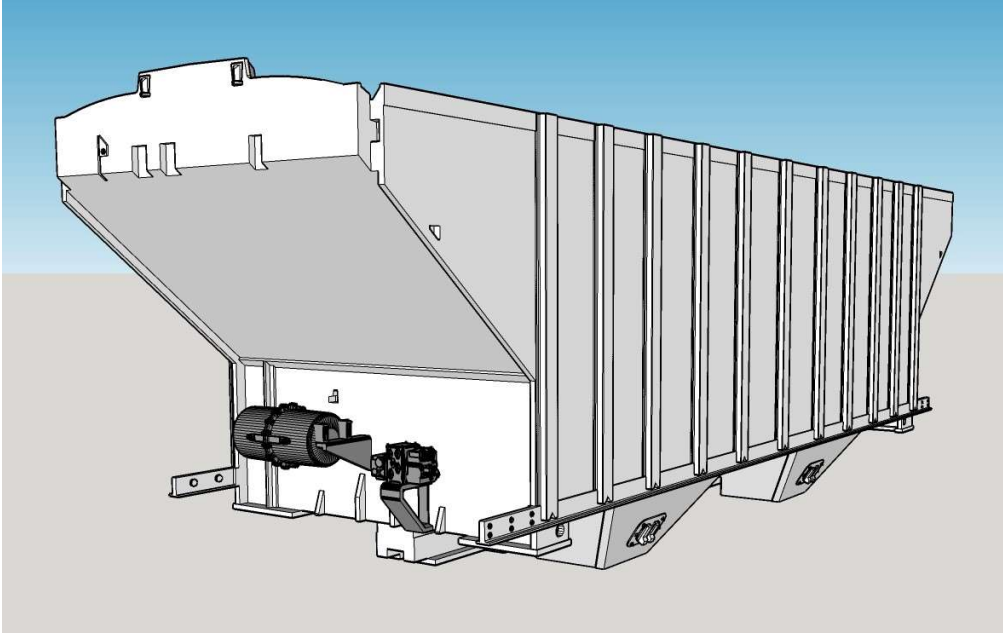

3. Install the B end cage. The brake cylinder beam fits in a hole in the vertical face of the end wall. The bottom rail tail has 2 nubs that fit into corresponding holes of the rail of the cage.

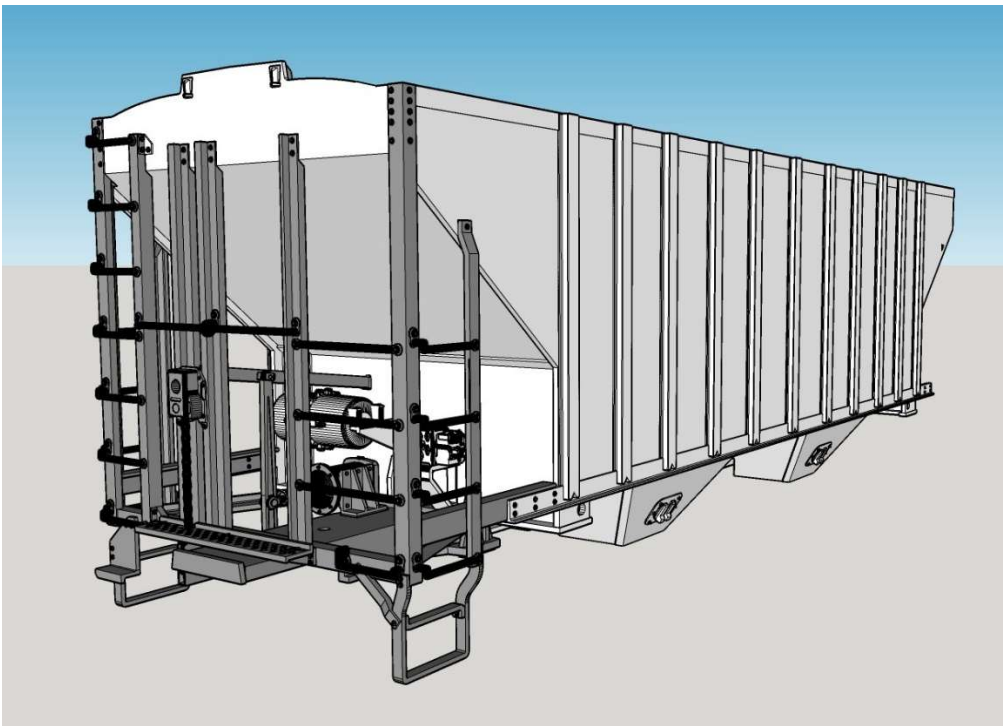

4. Install the A end cage.

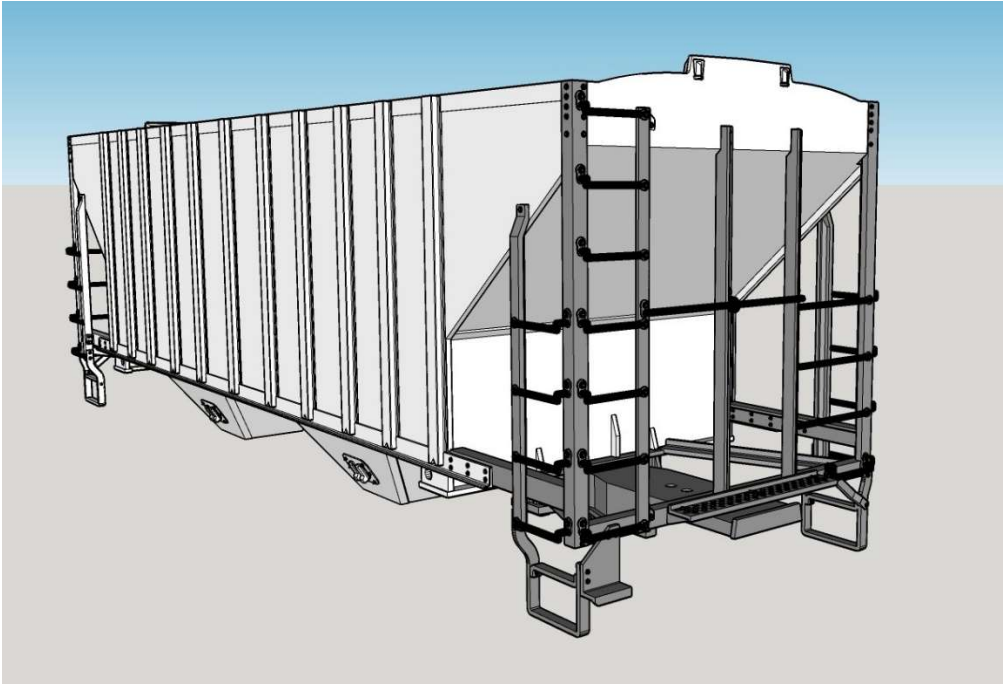

5. Install the roof. Add weight before installing the roof. If using non-stick weight, skip to step 7 to install discharge gates. Return to this step after weight is added.

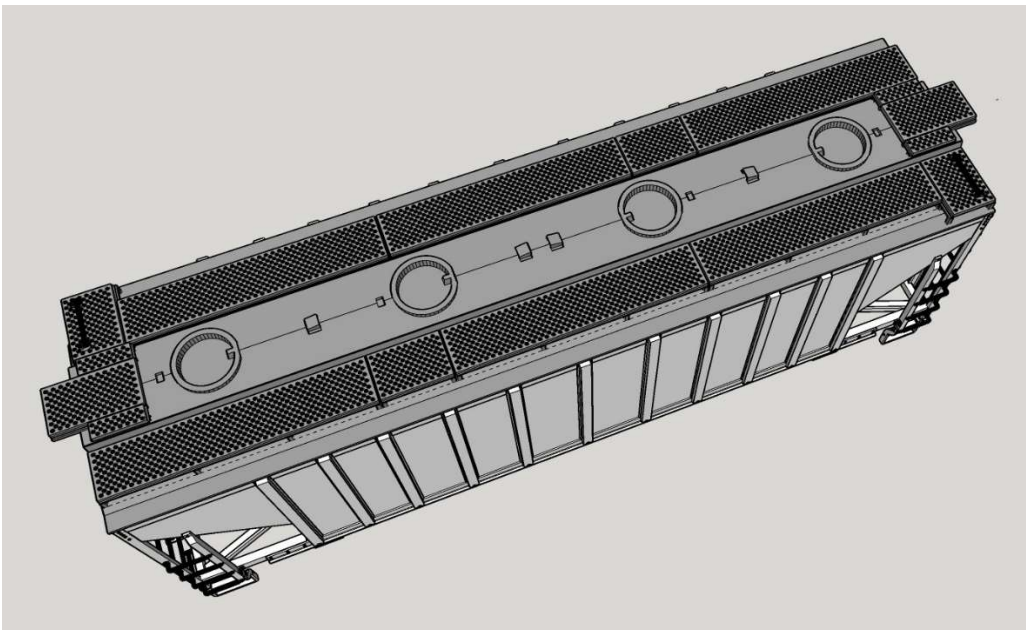

6. Install the roof hatches.

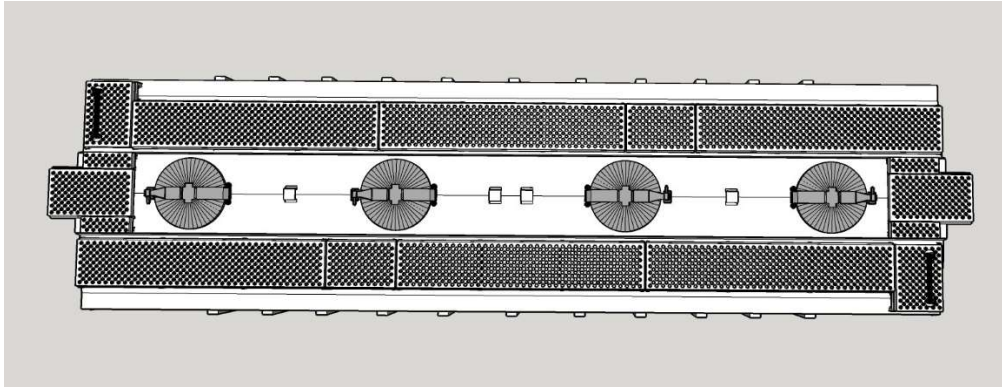

7. Install the hopper discharge doors.

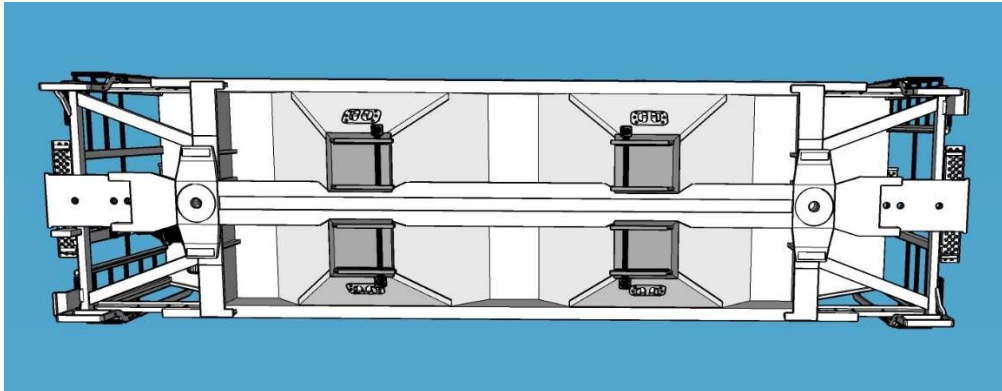

8. Install the draft gear with Kadee 802, 803, 807 or 808 couplers. Use the 00-800 flat head machine screws to attach the box to the pad.
 - Kadee draft gear can be used but some shims will have to be added to the trucks to adjust for the thickness of the box cover.

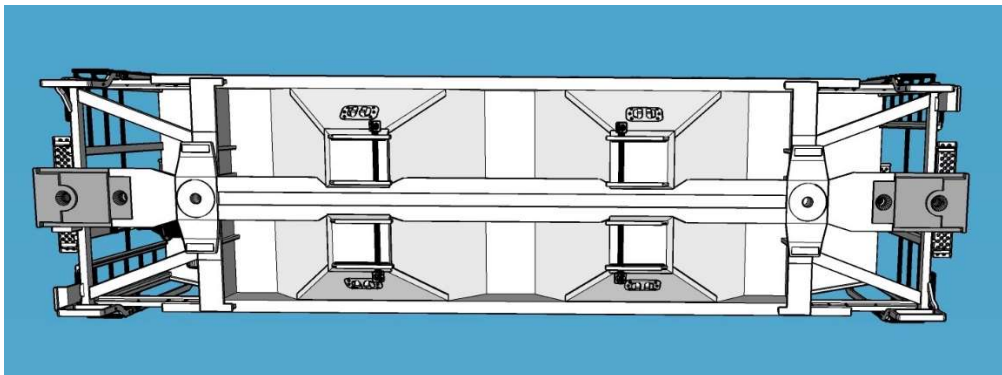

9. Install the brake wheel.

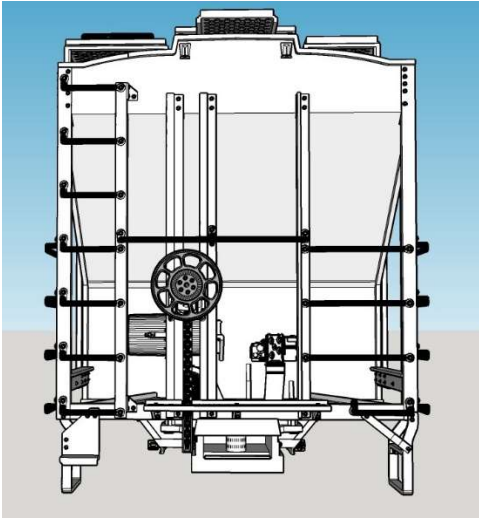

10. Install the trucks. The car is designed for 100 ton trucks with 36" wheels. Washers are required if 33" are used in order to attain the correct coupler height. Using Kadee #208 and #209 washers provide the right height correction.

